

# TECH 500

## Waterproofing membrane

### Description

Pre-fabricated waterproofing membrane made of distilled bitumen and elastomeric polymers (SBS).

The versions P & PA have a woven non woven single strand composite polyester reinforcement, with good mechanical characteristics and excellent dimensional stability.

The versions PA are self-protected on the upper face with mineral slates which reduce superficial heat absorption improving the durability of the membrane.

The self-protected versions have a side selvedge of 10 cm and upon request a head selvedge of 15 cm, to improve adhesion between the sheets.

### Stratigraphy

1. Polypropylene film
2. Waterproofing mass
3. Single strand composite polyester fabric
4. Waterproofing mass
- 5a. Polypropylene mat finish
- 5b. Mineral finish

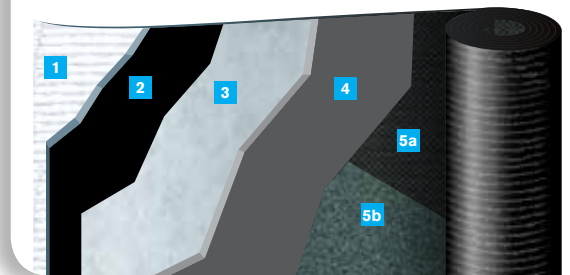

### Methods of application

For the application of the membrane the use of heat is generally used by means of a gas torch or specific hot air machine. Use protective devices required by law. The application by heat is not suggested when on heat sensitive materials (polystyrene insulation).

- Coordinate the operations in a way to not cause damage to the construction elements and underground structure. Avoid to leave the structure for the night or for periods of prolonged work interruptions without having been properly sealed.
- **The application surface must not have any depressions to avoid the risk of ponding water, the slope must be at least 1.5% on concrete decks and 3% for steel or wooden ones, this to guarantee a proper run off of rainwater.**
- The water drainage spouts should be sufficiently big enough to allow for rain water to be eliminated in an efficient way.
- Prepare cementitious substrates, including verticals and details, with a bituminous primer either by brush or airless, approx. 300/400 gr/m<sup>2</sup>.

- Allow this preparation layer to dry before proceeding with any other operation.
- With prefabricated constructions, apply a suitable reinforcing strip along all joints. In the presence of construction joints, prefabricated panels or metal decks, suitable expansion joints are to be considered.

The membranes must be applied to the substrate fully bonded. In any case, when in the proximity of the head laps, the membrane must be applied for at least 100 cm; furthermore all details, perimeters, verticals, change of slope as well as projecting area must be fully bonded.

For further information and news it is recommended to consult the PLUVITEC technical literature; our Technical Office is always available to evaluate particular problems and to provide the necessary assistance to best apply our waterproofing membranes.

### Fields of use



#### EN13707 Continuous roofs (Certificate n° 0958-CPR-2045/1)

	N° layers				Method of application					Type of application			Type				
	Single Layer	Double Layer	Multilayer	Torch	Hot Air	Mixed (Torch / Air)	Cold Bond Glue	Mechanical Fixing	Thermo Adhesive / Self Adhesive	Fully Bonded	Partially Bonded	Loose Laid	Complimentary Layer	Top Layer	Heavy Protection	Anti-root	Other Uses
TECH 500 P 3 MM		▪	▪	▪				▪		▪			▪				
TECH 500 P 4 MM		▪	▪	▪				▪		▪			▪				
TECH 500 PA 4.0 KG/M <sup>2</sup>		▪	▪	▪						▪				▪			
TECH 500 PA 4.5 KG/M <sup>2</sup>		▪	▪	▪						▪				▪			

#### EN13859-1 Under roof tile

TECH 500 PA 4.0 KG/M <sup>2</sup>	▪	▪	▪	▪						▪				▪			
TECH 500 PA 4.5 KG/M <sup>2</sup>	▪	▪	▪	▪						▪				▪			

## How to apply

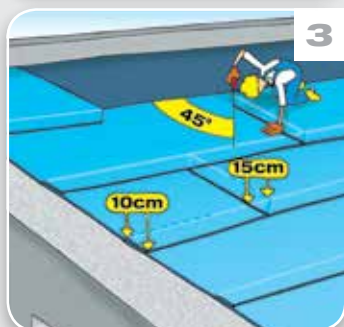
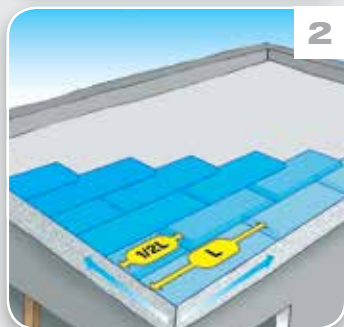
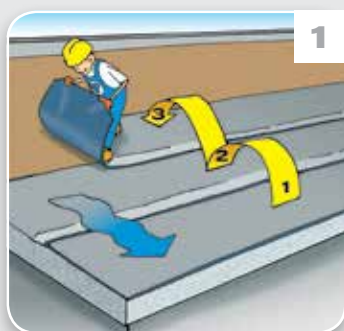

## Sizes & packing

	P 3 mm	P 4 mm	PA 4 kg/m <sup>2</sup>	PA 4,5 kg/m <sup>2</sup>
Rolls size [m]	10x1	10x1	10x1	10x1
Rolls per pallet	30	24	30	25
Square meters per pallet [m <sup>2</sup> ]	300	240	300	250

Sizes & packing may vary depending on the type of transportation. The technical data given is based on average values obtained during production. We reserve the rights to change or modify the nominal values without prior notice or advice. The information contained in this data sheet are based on our experience. We cannot take any responsibility for a possible incorrect use of the products. The customer has to choose under their own responsibility a product fit for the intended use.

# TECH 500

## Application

- On cementitious surfaces and similar apply, by roller or airless, bituminous primer, approx. consumption 300 gr/m<sup>2</sup>.
- Apply by torch application a 25 cm strip of membrane reinforced with polyester along all vertical up stands.
- To have all overlaps with the slope, position the membrane always starting from the lowest point. (Draw. N.1)
- Position the membrane sheets staggered, avoiding to create any overlaps against the slope and the drains. (Draw. N.2)
- Cut the corners of membrane sheet which will be laid under the next sheet at a 45° angle (10 x 10 cm). (Draw. N.3)
- The joints, both side and head, must be respectively overlapped by 10 & 15 cm. (Draw. N.3)
- The second layer of membrane will be applied astride and over the first one, always in the same direction, and approx. 1/4 of its length from the previous sheet. (Draw. N.4)
- The bituminous membrane will be applied with a propane gas torch to the substrate. It is necessary to heat the entire surface, except for the side & head laps, making sure that the compound forms a liquid mass in front of the roll to assure that it saturates any superficial porosity.
- The side laps (10 cm) and head laps (15 cm) will be heat welded with an appropriate torch; during this stage the overlaps should be pressed by using a roller (15 kg) from which a bead of compound should flow and therefore avoiding to have to iron the overlaps.
- Apply the vertical membrane sheet having the same characteristics of the waterproofing membrane and dimensions equal to the width of the roll, making sure that it overlaps the horizontal one by at least 10 cm, heating it with a gas torch and squeezing it with a trowel until a bead of compound appears from underneath.
- The height of the verticals must be equivalent or superior to the finished surface by at least 15 cm.

## Recommendations

To best use the technical characteristics of bituminous membranes and guarantee the maximum performance and durability of the jobs where they are used, some simple but fundamental rules must be respected.

- The rolls are to be stored in an upright position, preferably indoors in a dry and ventilated area, away from heat sources and avoiding to stack them one on top of the other to avoid possible deformations which may compromise the application. When storing with original packaging, pallets should not be stacked.
- The rolls shall be kept in a warm or heated storage area during application, should the workability of the material deteriorate or become stiff and difficult to install during application, these should be returned to the heated storage area and substituted with new rolls. The rolls that are temporarily stored on the roof before application, shall be kept elevated by being left on their own pallets and shall be covered and protected from the weather.
- The application surface must be smooth dry & clean.
- The application surface must be previously treated with a suitable bituminous primer, to eliminate dust and enhance the adhesion of the membrane.
- The application surface must not have any depressions to avoid the risk of ponding water; the slope must be at least 1.5% on concrete decks and 3% for steel or wooden ones, this to guarantee a proper run off of rainwater.
- In situations of application on vertical surfaces superior to 2 meters or on very sloped substrates, apply suitable mechanical fixings to the head laps, after which they will be sealed when torching the head laps.
- The application must be done at temperature higher than +5°C.
- The application must be interrupted in adverse weather conditions (high humidity, rain, etc.).
- Roofs waterproofed with elastomeric membranes must have the last layer self protected with mineral slates. As an alternative, depending on the type of structure, it is possible to use heavy protection (gravel, floating pavements, etc.).
- The pallets on which the rolls are packaged are intended for normal warehouse use.
- The materials on stock should be rotated following a first in first out rotation.

## Technical data

Technical Characteristics	Measure Units	Reference Norm	P	PA	Tolerance
Type of reinforcement			Single strand polyester		
Upper face finish			PPL mat	Mineral *	
Lower face finish			Polypropylene film		
Length	m	EN 1848-1	10 -1%		
Width	m	EN 1848-1	1 -1%		
Thickness	mm	EN 1849-1	3	4	±5%
Mass	kg/m <sup>2</sup>	EN 1849-1		4,0	±10%
Cold flexibility	°C	EN 1109	-15		
Cold flexibility after ageing	°C	EN 1296		-5	+15°C
Flow resistance	°C	EN 1110	100		
Tensile strength L / T	N / 5 cm	EN 12311-1	500/400		-20%
Elongation at break L / T	%	EN 12311-1	35/35		-15
Tearing resistance L / T	N	EN 12310-1	140/140		-30%
Dimensional stability	%	EN 1107-1	-0,3		
Loss mineral	%	EN 12039		30	
Fire resistance		EN 13501-5	F ROOF		
Fire reaction		EN 13501-1	F		
Tensile strength after ageing L / T	N / 5 cm	EN 1296		NPD	-20%
Elongation at break after ageing L / T	%	EN 1296		NPD	-15
Impermeability after artificial ageing	kPa	EN 1296	60		
Watertightness	kPa	EN 1928	60		

\* It is impossible to guarantee the color uniformity on self protected mineral membranes as the suppliers of the same do not provide any also. All self protected mineral finished membranes undergo color variations over time due to the exposure to atmospheric agents. Normally these variations in time will gradually become uniform.

NPD = No Performance Declared in accordance with the EU Construction Products Directive.