

# PLURA SELF-ADHESIVE ZERO

## new waterproofing composite self-adhesive membrane

### Description

The bitumen-polymer PLURA SELF-ADHESIVE ZERO membranes are the arrival point of the latest generation of membranes denominated "composite".

These membranes are thus defined because thanks to a production technology developed in 1995, Pluvitec can produce materials with differentiated waterproofing mass, which allows the optimal use of each layers properties, satisfying the different requirements.

PLURA SELF-ADHESIVE ZERO has a continuous single strand composite woven non woven polyester reinforcement with high mechanical characteristics.

### Main advantages

- The PA version upper face is self protected with mineral slates which reduce the absorption of heat on the membrane surface; **this version is equipped with a special 10 cm side selvedge that increases membrane adhesion and facilitates application.**
- **FASTER APPLICATION, AS IT IS NO LONGER REQUIRED TO REMOVE THE SELVEDGE.**
- **IN THIS PRODUCT, THE LOWER FACE ADHESIVE COMPOUND ABSOLUTELY ADHERES TO THE SPECIAL SELVEDGE.**
- **After applying the product directly on the substrate and removing the lower face silicon release film, it is possible to mechanically fasten it directly to the selvedge.**
- The P version upper face is self protected with a **special film with a particular geometric serigraphy**, specially designed to facilitate the application. The P 2 mm version can have a polypropylene mat finish.

PLURA SELF-ADHESIVE ZERO is an innovative self-adhesive membrane with increased adhesiveness, enhanced resistance of the adhesion to aging and the cold (the product maintain good adhesion even at low temperatures).

### Stratigraphy

1. Silicon release film
2. Self-adhesive waterproofing compound
3. Compatibility compound
4. Continuous single strand composite woven non woven polyester reinforcement
5. Compatibility compound
6. Self-adhesive waterproofing compound
- 7a. Mineral finish
- 7b. Polypropylene mat finish
- 7c. Special printed film finish
8. Special selvedge

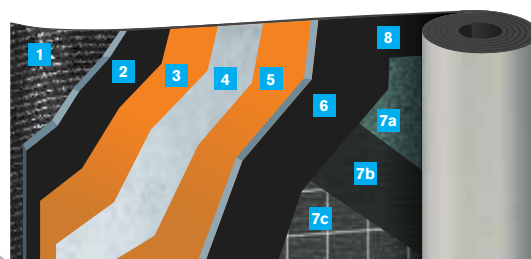

The PLURA SELF-ADHESIVE ZERO membranes are capable of resolving specific application and functional requirements and present numerous and important advantages, such as ease of application with consequential savings on time and the possibility to apply the material on surfaces which are not suitable to open flame.

Therefore PLURA SELF-ADHESIVE ZERO is insuperable in the waterproofing of wood structures, insulation panels which are heat sensitive, panel decks and refurbishment of historical roofs.

Furthermore PLURA SELF-ADHESIVE ZERO can be used and allows the waterproofing of particular roof details (ex. bandaging of plastic tubes, etc.) and the possibility to also apply with the traditional application method of open flame or hot air, obtaining an exceptional level of adhesion.

PLURA SELF-ADHESIVE ZERO guarantees a perfect level of adhesion to the application surface, providing the system with an excellent level of wind uplift resistance and allowing accidental infiltrations to be traced.

### Fields of use



#### EN13707 Continuous roofs (Certificate n° 0958-CPR-2045/1)

	N° layers			Method of application						Type of application			Type				
	Single Layer	Double Layer	Multilayer	Torch	Hot Air	Mixed (Torch / Air)	Cold Bond Glue	Mechanical Fixing	Thermo Adhesive / Self-Adhesive	Fully Bonded	Partially Bonded	Loose Laid	Complementary Layer	Top Layer	Heavy Protection	Anti-root	Other Uses
PLURA SELF-ADHESIVE ZERO P 2 MM		■	■						■	■			■				
PLURA SELF-ADHESIVE ZERO P 3 MM		■	■						■	■			■				
PLURA SELF-ADHESIVE ZERO P 4 MM		■	■						■	■			■				
PLURA SELF-ADHESIVE ZERO PA 3.5 KG/M²		■	■						■	■			■				
PLURA SELF-ADHESIVE ZERO PA 4.0 KG/M²		■	■						■	■			■				
PLURA SELF-ADHESIVE ZERO PA 4.5 KG/M²		■	■						■	■			■				

#### EN13859-1 Under roof tile

PLURA SELF-ADHESIVE ZERO PA 3.5 KG/M²	■	■	■						■	■				■			
PLURA SELF-ADHESIVE ZERO PA 4.0 KG/M²	■	■	■						■	■				■			
PLURA SELF-ADHESIVE ZERO PA 4.5 KG/M²	■	■	■						■	■				■			

## How to apply



1



2



3

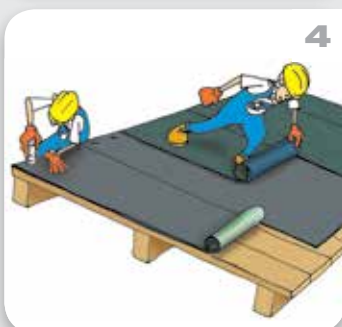

4

## PLURA SELF-ADHESIVE ZERO

### Application

1. On cementitious surfaces and similar apply, by roller or airless, synthetic primer PRIMER SINT, approx. consumption 200-400 g/m<sup>2</sup>. This application is not required on wooden roofs except OSB boards.
2. Position the PLURA SELF-ADHESIVE ZERO on the application surface; provide side & head laps respectively of 10 & 15 cm's between the sheets. (Draw. N.1)
3. Remove the release film from the lower face, this is divided longitudinally in two sections, in one or two steps. It is always suggested to mechanically fix head & side laps. (Draw. N.2)
4. Use suitable roller by applying pressure over all of the membrane surface, particularly the side & head laps to further promote adhesion.
5. Position suitable single or double battens for subsequent laying of the sealing element consisting of a discontinuous covering mantle (tiles, roof tiles, etc.) as required by the UNI 9460: 2008 standard - Discontinuous roofing for roofs. (Draw. N.3)
6. In the event of high internal relative humidity, or the presence of humidity in the wooden deck application surface, to prevent the formation of condensation on the inner face of the adhesive membrane during the night, which may cause marks or stains over time in the ceiling of the rooms below, foresee the use of MONOTEC vapor separation and diffusion layer having a polypropylene film finish mechanically fixed to the support with broad-headed nails. The adhesive membrane is then applied over the vapor diffusion layer. (Draw. N.4)

### Recommendations

- The PLURA SELF-ADHESIVE ZERO membranes are to be applied on dry clean surfaces which must be treated with a synthetic primer, excluded are wooden roofs except OSB boards.
- Self-adhesive membranes must not be applied on sanded or talced underlays. The granulometry of these upper surfaces creates a detaching effect that prevents the self-adhering properties from achieving a fully bonded installation.

- The side & head laps must be respectively of 10 & 15 cm's.
- When applying on verticals, the apex of the membrane must be mechanically fixed with a proper flashing; where possible it is advisable to go up and over the vertical and on to the horizontal surface.
- Using the version with special printed film, immediately apply the finishing layer.
- Avoid storing the product on the roof with temperatures lower than +10°C or higher than +40°C if not for the time necessary for installation.
- With temperatures below +10°C it is necessary to apply the product using particular precautions:
  1. Store the rolls in an upright position in the original packaging, indoors and in dry and warm areas.
  2. Transport the rolls to the place of application only at the time of use.
  3. The ideal application occurs at temperatures above +10°C, however it is possible to apply the product below +5°C bringing the rolls to the ideal temperature with a leister or gas torch.
- **The application surface must not have any depressions to avoid the risk of ponding water, the slope must be at least 1.5% on concrete decks and 3% for steel or wooden ones, this to guarantee a proper run off of rainwater.**
- Program periodical roof inspections to remove debris, mud, plants, etc. and to keep under control the waterproofing as well as accessory details (drain outlets, TV antennas, air conditioning, etc.).
- In the eventuality in which the element to be waterproofed presents residual humidity (ex. refurbishment, application after heavy rains) it is necessary to foresee the use of air vents, which will be positioned in a way to allow for the evacuation of the humidity.
- Absolutely avoid the stacking of rolls and pallets for storage or transport to avoid possible deformations which may compromise a perfect installation. It is recommended to store the product at temperatures above 0°C.

# PLURA SELF-ADHESIVE ZERO

## Technical data

Technical Characteristics	Measure Units	Reference Norm	P			PA			Tolerance
			2	3	4	3,5	4,0	4,5	
Type of reinforcement			Single strand polyester						
Upper face finish			Polypropylene mat	Special printed film		Mineral *			
Lower face finish			Silicon release film						
Visible defects		EN 1850-1	No						
Straightness	mm/10 m	EN 1848-1	< 20						
Length	m	EN 1848-1	15 ±1%	10 ±1%					
Width	m	EN 1848-1	1 ±1%						
Thickness	mm	EN 1849-1	2	3	4				±5%
Mass	kg/m <sup>2</sup>	EN 1849-1				3,5	4,0	4,5	±10%
Cold flexibility	°C	EN 1109	-20						
Flow resistance	°C	EN 1110	100						
Tensile strength L / T	N / 5 cm	EN 12311-1	400/300	500/400		400/300			±20%
Elongation at break L / T	%	EN 12311-1	35/35						±15
Tearing resistance L / T	N	EN 12310-1	120/120	140/140		120/120			±30%
Dimensional stability	%	EN 1107-1	-0.3						
Fire resistance		EN 13501-5	F ROOF						
Fire reaction		EN 13501-1	F						
Watertightness	kPa	EN 1928	60						
Peel resistance on steel support	N/50 mm	UEAtc 4.3.3 ASTM D 1000	50						±20N
Peel resistance on steel support after ageing	N/50 mm	UEAtc 4.3.3 ASTM D 1000	100						±20N
Peel resistance at 180° on new polymeric selvage	N	EN 12316-1	50						±20N
Peel resistance at 180° on new polymeric selvage after ageing	N	EN 1296	150						±20N
Peel resistance at 180° on removable selvage	N	EN 12316-1	40						±20N
Peel resistance at 180° on removable selvage after ageing		EN 1296	130						±20N

\* Mineral self-protected products may undergo color tone variations due to the time and length of storage. Exposure to atmospheric conditions, after application, will tend to uniform the color after a few months. The change in color tone cannot therefore be contested and / or complained of as it is a natural phenomenon that the slate manufacturer himself cannot guarantee.

## Sizes & packing

	P 2 mm	P 3 mm	P 4 mm	PA 3,5 kg/m <sup>2</sup>	PA 4,0 kg/m <sup>2</sup>	PA 4,5 kg/m <sup>2</sup>
Rolls size [m]	15x1	10x1	10x1	10x1	10x1	10x1
Rolls per pallet	30	30	25	30	27	25
Square meters per pallet [m <sup>2</sup> ]	450	300	250	300	270	250

Sizes & packing may vary depending on the type of transportation. The technical data given is based on average values obtained during production. We reserve the rights to change or modify the nominal values without prior notice or advice. The information contained in this data sheet are based on our experience. We cannot take any responsibility for a possible incorrect use of the products. The customer has to choose under their own responsibility a product fit for the intended use.